

Notes

1. K11 415 15mm ply lining
2. K11 418 50mm Oak Bench or oak veneered plywood sandwich construction
3. N10 154 25mm dia. Shaped Oak pegs for bags / coats
4. K11 418 25mm ply shelves
5. P10 150 70mm rigid insulation between rafters - Kingspan Kooltherm K107 Pitched Roof Board
6. M60 170 Existing Walls Cleaned and Limewashed
7. M50 150 Marmoleum flooring on existing subfloor
8. New Door to match other outbuildings

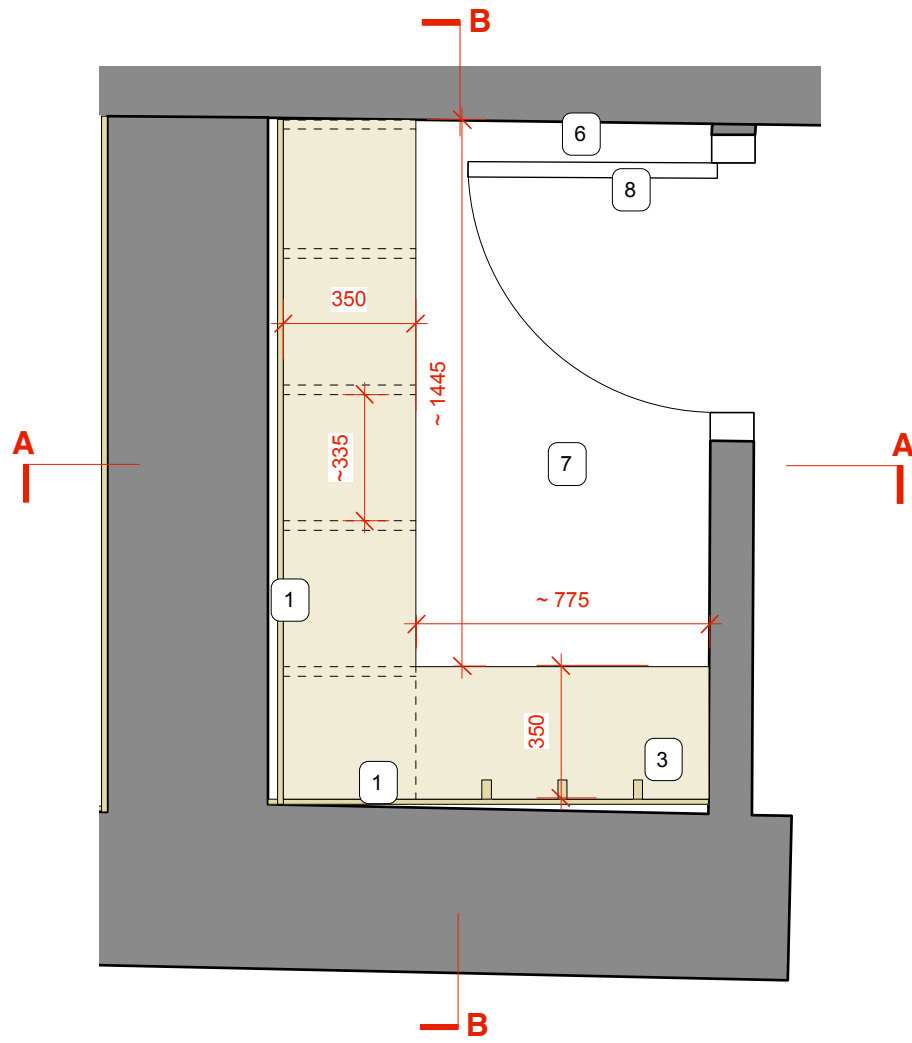

1 Plan
Scale: 1:20

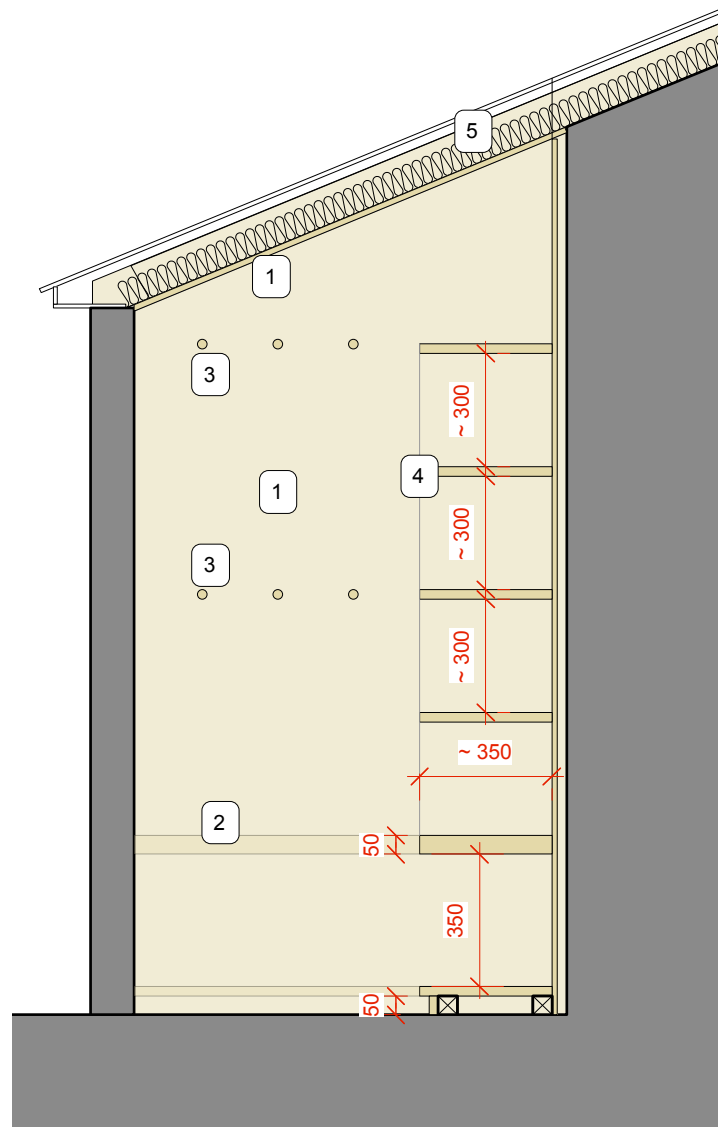

2 Scale: 1:20
Section A

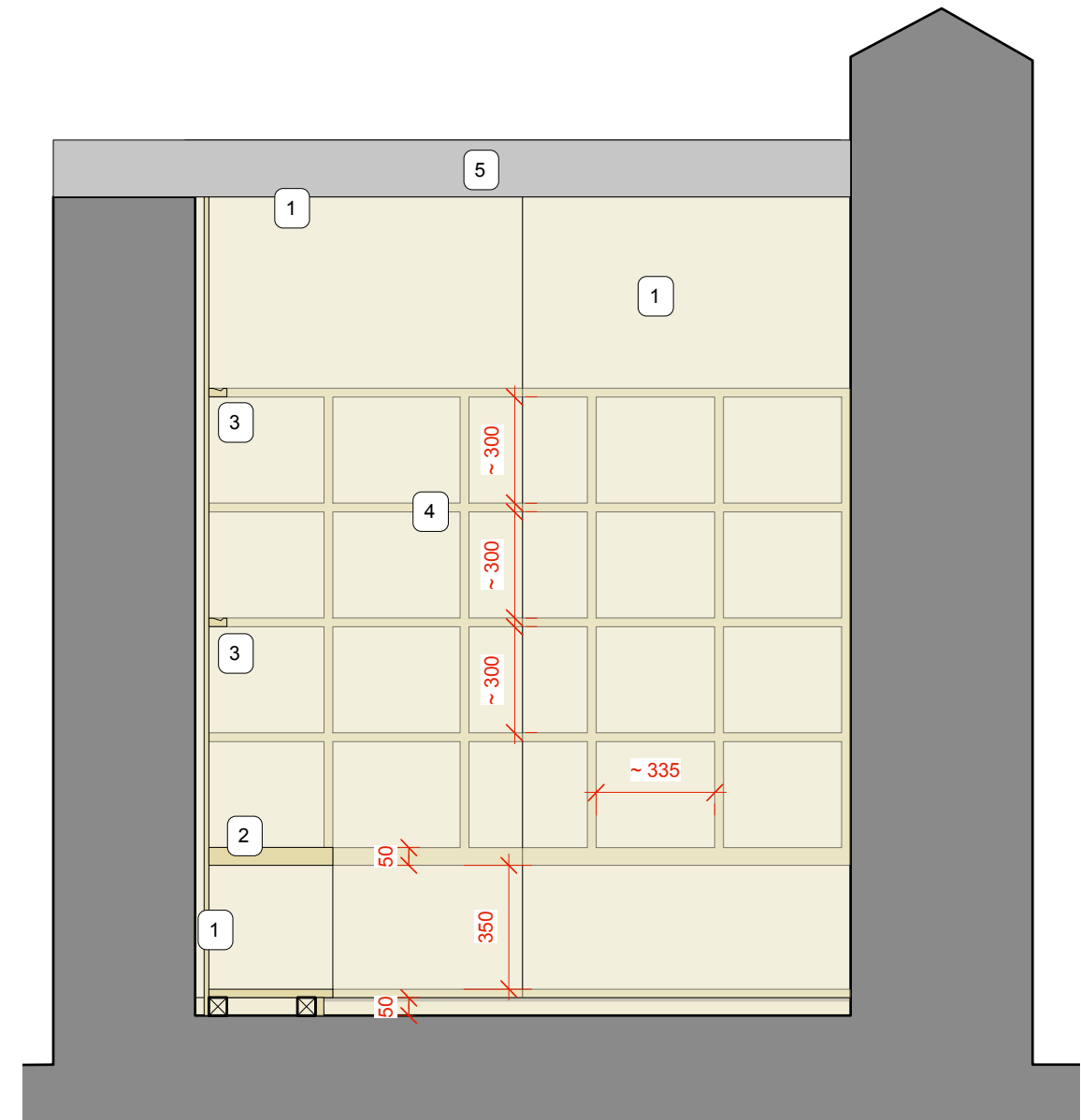

3 Scale: 1:20
Section B

<p>general</p> <ul style="list-style-type: none"> • all drawings are copyright • do not scale drawing • report all discrepancies to project administrator • all dimensions to be checked on site 	<p>key</p>	<p>notes</p> <p>Further Details of Finishes / Wall Floor / Ceiling Build-Ups on GA150.</p>	<p>rev</p> <p>---:---:---:---</p> <p>Stage 4 - TENDER ISSUE</p>	<table border="1"> <tr> <td>project:</td> <td>Tavistock Guildhall & Police Station</td> <td>date:</td> <td>March 2019</td> <td>scale:</td> <td>1:20 @ A3</td> <td>drawn:</td> <td>IF</td> </tr> <tr> <td>drawing title:</td> <td>School Bag Drop Details</td> <td>job no.:</td> <td>1041</td> <td>drawing no.:</td> <td>C-312</td> <td>rev.:</td> <td>-</td> </tr> <tr> <td colspan="8" style="text-align: center;">gillespie yunnie architects</td> </tr> <tr> <td colspan="8" style="text-align: center; font-size: small;">Lower Tweed Mill Shimmers Bridge Dartington Devon TQ9 6JB t 01803 860010 f 01803 864929 e info@gyarchitects.co.uk</td> </tr> </table>	project:	Tavistock Guildhall & Police Station	date:	March 2019	scale:	1:20 @ A3	drawn:	IF	drawing title:	School Bag Drop Details	job no.:	1041	drawing no.:	C-312	rev.:	-	gillespie yunnie architects								Lower Tweed Mill Shimmers Bridge Dartington Devon TQ9 6JB t 01803 860010 f 01803 864929 e info@gyarchitects.co.uk							
project:	Tavistock Guildhall & Police Station	date:	March 2019	scale:	1:20 @ A3	drawn:	IF																													
drawing title:	School Bag Drop Details	job no.:	1041	drawing no.:	C-312	rev.:	-																													
gillespie yunnie architects																																				
Lower Tweed Mill Shimmers Bridge Dartington Devon TQ9 6JB t 01803 860010 f 01803 864929 e info@gyarchitects.co.uk																																				