

**Ref: 1D03**  
**Location:** F36  
**Type:** Existing - door with painted finish to be removed and replaced with plain solid core fire door.  
**Proposed Works:** Fitted as per manufacturers recommendations  
**Ironmongery:** 5 - Standard 'd-line' type modern level handle. Hinges to be provided by door manufacturer. Door closer to be fitted. Mortice lock, suiting TBC by client with internal thumb turn.  
**Fire Rating:** FD30S  
**Acoustic Rating:** N/A  
**Glazing:** None.  
**Repair Code:** N/A  
**Finish:** Spray laquered off site finished - White - Colour TBC  
**Spec Ref:** L20 440

**Ref: 1D04**  
**Location:** F38  
**Type:** New plain solid core fire door.  
**Proposed Works:** Fitted as per manufacturers recommendations  
**Ironmongery:** 5 - Standard 'd-line' type modern level handle. Hinges to be provided by door manufacturer. Door closer to be fitted. Mortice lock, suiting TBC by client with internal thumb turn.  
**Fire Rating:** FD30S  
**Acoustic Rating:** N/A  
**Glazing:** None.  
**Repair Code:** N/A  
**Finish:** Spray laquered off site finished - White - Colour TBC  
**Spec Ref:** L20 440

**Ref: 1D05**  
**Location:** F39  
**Type:** New plain solid core door.  
**Proposed Works:** Fitted as per manufacturers recommendations  
**Ironmongery:** 5 - Standard 'd-line' type modern level handle. Hinges to be provided by door manufacturer. Door closer to be fitted. Mortice lock, suiting TBC by client with internal thumb turn.  
**Fire Rating:** N/A  
**Acoustic Rating:** N/A  
**Glazing:** None.  
**Repair Code:** N/A  
**Finish:** Spray laquered off site finished - White - Colour TBC  
**Spec Ref:** L20 430

**Ref: F36-cpd-01**  
**Location:** F36  
**Type:** Existing - timber panelled door with painted finish  
**Proposed Works:** Existing cupboard door to be retained and made good where required.  
**Ironmongery:** As existing with thumbturn lock retained if servicable. Check and ease movement.  
**Fire Rating:** N/A  
**Acoustic Rating:** N/A  
**Glazing:** None.  
**Repair Code:** 2  
**Finish:** White - Colour TBC.  
**Spec Ref:** L20 275

**Ref: F36-cpd-02**  
**Location:** F36  
**Type:** New - timber panelled door to match F36-cpd-01 with painted finish  
**Proposed Works:** New Cupboard to be installed  
**Ironmongery:** As existing with thumbturn lock retained if servicable.  
**Fire Rating:** N/A  
**Acoustic Rating:** N/A  
**Glazing:** None.  
**Repair Code:** N/A  
**Finish:** White - Colour TBC.  
**Spec Ref:** L20 400 - To match F36-cpd-01

**Ref: 1D06**  
**Location:** F39  
**Type:** Existing - timber panelled door with painted finish  
**Proposed Works:** Existing door to be retained and made good where required. Door upgraded to meet FD30 using intumescent paint and or intumescent cloth as required. Intumescent smoke seals to be installed.  
**Ironmongery:** 2 - As existing with door closer fitted. Check and ease movement. 'Salto' Access Equipped.  
**Fire Rating:** FD30S  
**Acoustic Rating:** N/A  
**Glazing:** None.  
**Repair Code:** 2  
**Finish:** White - Colour TBC.  
**Spec Ref:** L20 273

**Ref: 1D07**  
**Location:** F44  
**Type:** Existing - timber panelled door with painted finish  
**Proposed Works:** Existing door to be retained and made good where required. Door upgraded to meet FD30 using intumescent paint and or intumescent cloth as required. Intumescent smoke seals to be installed.  
**Ironmongery:** 2 - New antique brass / bronze knob + associated ironmongery with door closer fitted. Lock removed and infilled for fire protection.  
**Fire Rating:** FD30S  
**Acoustic Rating:** N/A  
**Glazing:** None.  
**Repair Code:** 2  
**Finish:** White - Colour TBC.  
**Spec Ref:** L20 273

**Ref: F44-cpd-01**  
**Location:** F44  
**Type:** Existing - timber panelled door with painted finish  
**Proposed Works:** Existing cupboard door to be retained and made good where required.  
**Ironmongery:** New antique brass / bronze knob + associated ironmongery with lock. Check and ease movement.  
**Fire Rating:** N/A  
**Acoustic Rating:** N/A  
**Glazing:** None.  
**Repair Code:** 1  
**Finish:** White - Colour TBC.  
**Spec Ref:**

Ref:	Legend
<b>Door repair codes</b>	
1.	Good - sound and operational - prepare surfaces and redecorate.
2.	Intact - ease and free-up moving parts, address surface defects adjust, redecorate.
3.	Moderate - Requires repair, adjustment, refurbishment prior to redecoration.
4.	Poor - significant repairs, alterations or new components needed to make operational. Adjust, redecorate.
5.	Beyond economic repair - remove. Prepare opening for replacement unit.

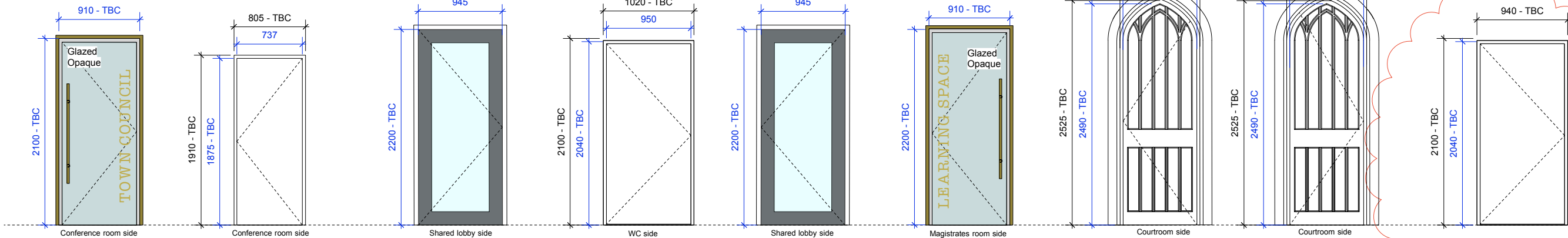
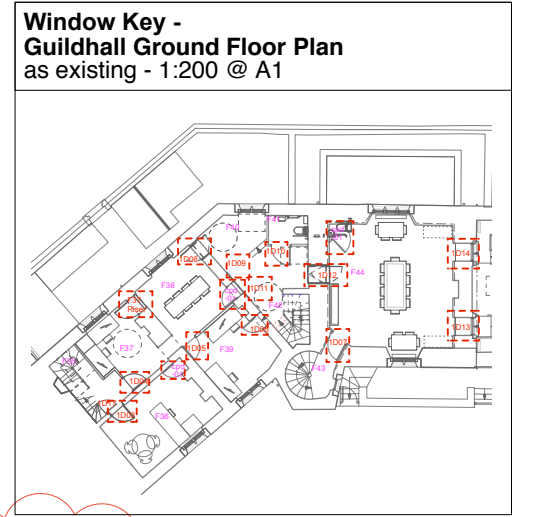

**Ref: 1D08**  
**Location:** F38  
**Type:** Proposed - Glazed Fire rated single door with steel lined surround  
**Proposed Works:** Toughened fire rated glazed door fixed at joints using specialist hinges. Door opening lined with Bronze polyester powder coated steel surround.  
**Ironmongery:** 1A - Hinges to be provided by door manufacturer. Door closer. Mag lock linked to secure card access System ('Salto' Type - Refer M+E Specification). Bronze steel 'bar' handles fixed to both sides of door.  
**Fire Rating:** FD30S  
**Acoustic Rating:** N/A  
**Glazing:** Toughened translucent laminate glazing with manifestation - TBC  
**Repair Code:** N/A  
**Finish:**  
**Spec Ref:** L10 562

**Ref: F38-cpd-01**  
**Location:** F38  
**Type:** New plain solid core cupboard door.  
**Proposed Works:** Fitted as per manufacturers recommendations  
**Ironmongery:** 9 - Standard 'd-line' type modern level handle. Hinges to be provided by door manufacturer.  
**Fire Rating:** N/A  
**Acoustic Rating:** N/A  
**Glazing:** None.  
**Repair Code:** N/A  
**Finish:** Spray laquered off site finished - White - Colour TBC  
**Spec Ref:** L20 430

**Ref: 1D09**  
**Location:** F42  
**Type:** New Door Supplied by Lift Manufacturer  
**Proposed Works:** Fitted as per manufacturers recommendations  
**Ironmongery:** L - To be provided by manufacturer. Access Controlled  
**Fire Rating:** N/A  
**Acoustic Rating:** N/A  
**Glazing:** N/A  
**Repair Code:** N/A  
**Finish:** Dark Grey - to match Lift with glazed panel - TBC  
**Spec Ref:** X12 110

**Ref: 1D10**  
**Location:** F41  
**Type:** New plain solid core door.  
**Proposed Works:** Fitted as per manufacturers recommendation. Undercut door by 10mm - TBC by M+E Engineer.  
**Ironmongery:** 8 - To be provided by manufacturer. TBC. Accessible Fittings including thumbturn lock with indicator. Access. WC Signage.  
**Fire Rating:** N/A  
**Acoustic Rating:** N/A  
**Glazing:** N/A  
**Repair Code:** N/A  
**Finish:** White - TBC. Accessible WC Signage.  
**Spec Ref:** L20 430

**Ref: 1D11**  
**Location:** F40  
**Type:** New Door Supplied by Lift Manufacturer  
**Proposed Works:** Fitted as per manufacturers recommendations  
**Ironmongery:** L - To be provided by manufacturer. Access Controlled.  
**Fire Rating:** N/A  
**Acoustic Rating:** N/A  
**Glazing:** N/A  
**Repair Code:** N/A  
**Finish:** Dark Grey - to match Lift with glazed panel - TBC  
**Spec Ref:** X12 110

**Ref: 1D12**  
**Location:** F44  
**Type:** Proposed - Glazed Fire rated single door with steel lined surround  
**Proposed Works:** Toughened fire rated glazed door fixed at joints using specialist hinges. Door opening lined with Bronze polyester powder coated steel surround.  
**Ironmongery:** 1A - Hinges to be provided by door manufacturer. Door closer. Mag lock linked to secure card access System ('Salto' Type - Refer M+E Specification). Bronze steel 'bar' handles fixed to both sides of door.  
**Fire Rating:** FD30S  
**Acoustic Rating:** N/A  
**Glazing:** Toughened translucent laminate glazing with manifestation - TBC  
**Repair Code:** N/A  
**Finish:**  
**Spec Ref:** L10 562

**Ref: 1D13**  
**Location:** F45  
**Type:** Existing - timber panelled door with painted finish  
**Proposed Works:** Existing door to be retained and made good where required.  
**Ironmongery:** New antique brass / bronze knob + associated ironmongery.  
**Fire Rating:** N/A  
**Acoustic Rating:** N/A  
**Glazing:** None.  
**Repair Code:** 2  
**Finish:** White - Colour TBC.  
**Spec Ref:** L20 275

**Ref: 1D14**  
**Location:** F45  
**Type:** Existing - timber panelled door with painted finish  
**Proposed Works:** Existing door to be retained and made good where required.  
**Ironmongery:** New antique brass / bronze knob + associated ironmongery.  
**Fire Rating:** N/A  
**Acoustic Rating:** N/A  
**Glazing:** None.  
**Repair Code:** 2  
**Finish:** White - Colour TBC.  
**Spec Ref:** L20 275

**Ref: F37 Riser Door**  
**Location:** F37 Riser  
**Type:** New plain solid core fire door.  
**Proposed Works:** Fitted as per manufacturers recommendations  
**Ironmongery:** 5 - Standard 'd-line' type modern level handle. Hinges to be provided by door manufacturer. Door closer to be fitted. Mortice lock, suiting TBC by client with internal thumb turn.  
**Fire Rating:** FD30S - TBC by M+E Engineer  
**Acoustic Rating:** N/A  
**Glazing:** None.  
**Repair Code:** N/A  
**Finish:** Spray laquered off site finished - White - Colour TBC  
**Spec Ref:** L20 440

<b>general</b> <ul style="list-style-type: none"> <li>all drawings are copyright</li> <li>do not scale drawing</li> <li>report all discrepancies to project administrator</li> <li>all dimensions to be checked on site</li> </ul>	<b>key</b>	<b>notes</b> <h2>Stage 4 - Tender</h2> <p>All dimensions to be checked on site.  <b>Note:</b> Door undercuts and Louvre Panels to be confirmed by M+E Engineer</p>	<b>rev</b> <b>T1:</b> 21.03.19 - Door Updates as noted or bubbled <b>T2:</b> 04.04.19 - Door Updates as noted in Red or bubbled	<b>project title:</b> Tavistock Guildhall and Police Station	<b>date:</b> October 2018	<b>scale:</b> 1:25 @ A1 1:50 @ A3	<b>drawn:</b> cm
				<b>drawing title:</b> Internal Door Schedule 3 - First Floor	<b>job no.:</b> 1041	<b>drawing no.:</b> C-382	<b>rev.:</b> T1
<b>gillespie yunnie architects</b>							
Lower Tweed Mill Shimmers Bridge Dartington Devon TQ9 6JB 01803 860010 01803 864929 e:info@gyarchitects.co.uk							