

**Ref: 2D01**

**Location:** S50  
**Type:** New plain solid core fire door.  
**Proposed Works:** Fitted as per manufacturers recommendations  
**Ironmongery:** 5 - Standard 'd-line' type modern level handle. Hinges to be provided by door manufacturer. Door closer to be fitted. Mortice lock, suiting TBC by client with internal thumb turn.  
**Fire Rating:** FD30S  
**Acoustic Rating:** N/A  
**Glazing:** None.  
**Repair Code:** N/A  
**Finish:** Spray laquered off site finished - White - Colour TBC  
**Spec Ref:** Spec Ref: L20 440

**Ref: 2D02**

**Location:** S51  
**Type:** New plain solid core fire door.  
**Proposed Works:** Fitted as per manufacturers recommendations  
**Ironmongery:** 5 - Standard 'd-line' type modern level handle. Hinges to be provided by door manufacturer. Door closer to be fitted. Mortice lock, suiting TBC by client with internal thumb turn.  
**Fire Rating:** FD30S  
**Acoustic Rating:** N/A  
**Glazing:** Toughened glass vision panel.  
**Repair Code:** N/A  
**Finish:** Spray laquered off site finished - White - Colour TBC  
**Spec Ref:** L20 440 + Vision Panel

**Ref: 2D03**

**Location:** S51  
**Type:** New plain solid core fire door.  
**Proposed Works:** Fitted as per manufacturers recommendations  
**Ironmongery:** 5 - Standard 'd-line' type modern level handle. Hinges to be provided by door manufacturer. Door closer to be fitted. Thumbturn Lock on both sides.  
**Fire Rating:** FD30S  
**Acoustic Rating:** N/A  
**Glazing:** Toughened glass vision panel.  
**Repair Code:** N/A  
**Finish:** Spray laquered off site finished - White - Colour TBC  
**Spec Ref:** L20 440 + Vision Panel

**Ref: 2D04**

**Location:** S52  
**Type:** Proposed - Glazed Fire rated single door with steel lined surround  
**Proposed Works:** Toughened fire rated glazed door fixed at jambs using specialist hinges. Door opening lined with Bronze polyester powder coated steel surround.  
**Ironmongery:** 1A - Hinges to be provided by door manufacturer. Door closer. Mag lock linked to secure card access System ('Salto' Type - Refer M+E Specification). Bronze steel 'bar' handles fixed to both sides of door.  
**Fire Rating:** FD30S  
**Acoustic Rating:** N/A  
**Glazing:** Toughened translucent laminate glazing with manifestation - TBC  
**Repair Code:** N/A  
**Finish:** Spray laquered off site finished - White - Colour TBC  
**Spec Ref:** L20 440 + Vision Panel

**Ref: 2D05**

**Location:** S53  
**Type:** New Door Supplied by Lift Manufacturer  
**Proposed Works:** Fitted as per manufacturers recommendations  
**Ironmongery:** L - To be provided by manufacturer. Access Controlled  
**Fire Rating:** N/A  
**Acoustic Rating:** N/A  
**Glazing:** N/A  
**Repair Code:** N/A  
**Finish:** Dark Grey - to match Lift with glazed panel - TBC  
**Spec Ref:** X12 110

**Ref: 2D06**

**Location:** S54  
**Type:** New plain solid core door.  
**Proposed Works:** Fitted as per manufacturers recommendations  
**Ironmongery:** 4 - Standard 'd-line' type modern level handle. Hinges to be provided by door manufacturer. Door opening lined with Bronze polyester powder coated steel surround.  
**Fire Rating:** N/A  
**Acoustic Rating:** N/A  
**Glazing:** Toughened glass vision panel.  
**Repair Code:** N/A  
**Finish:** Spray laquered off site finished - White - Colour TBC. WC signage.  
**Spec Ref:** L20 430

**Ref: 2D07**

**Location:** S56  
**Type:** Proposed - Glazed Fire rated single door with steel lined surround  
**Proposed Works:** Toughened fire rated glazed door fixed at jambs using specialist hinges. Door opening lined with Bronze polyester powder coated steel surround.  
**Ironmongery:** 1A - Hinges to be provided by door manufacturer. Door closer. Mag lock linked to secure card access System ('Salto' Type - Refer M+E Specification). Bronze steel 'bar' handles fixed to both sides of door.  
**Fire Rating:** FD30S  
**Acoustic Rating:** N/A  
**Glazing:** Toughened translucent laminate glazing with manifestation - TBC  
**Repair Code:** N/A  
**Finish:** Spray laquered off site finished - White - Colour TBC. WC signage.  
**Spec Ref:** L20 430

**Ref: 2D10**

**Location:** S56  
**Type:** Existing - timber panelled door with painted finish to be replaced  
**Proposed Works:** Fitted as per manufacturers recommendations  
**Ironmongery:** 1 - Standard 'd-line' type modern level handle. Hinges to be provided by door manufacturer. Door closer to be fitted. Mag lock linked to secure card access System ('Salto' Type - Refer M+E Specification)  
**Fire Rating:** FD30S  
**Acoustic Rating:** N/A  
**Glazing:** Toughened glass vision panel.  
**Repair Code:** N/A  
**Finish:** Spray laquered off site finished - White - Colour TBC  
**Spec Ref:** L20 440 + Vision Panel

**Ref: 2D11**

**Location:** S55  
**Type:** New plain solid core fire door.  
**Proposed Works:** Fitted as per manufacturers recommendations  
**Ironmongery:** 6 - Standard 'd-line' type modern level handle. Hinges to be provided by door manufacturer. Door closer to be fitted.  
**Fire Rating:** FD30S  
**Acoustic Rating:** N/A  
**Glazing:** Toughened glass vision panel.  
**Repair Code:** N/A  
**Finish:** Spray laquered off site finished - White or Dark Grey - Colour TBC  
**Spec Ref:** L20 440 + Vision Panel  
**NOTE:** Building Control have confirmed that door is required with vision panel

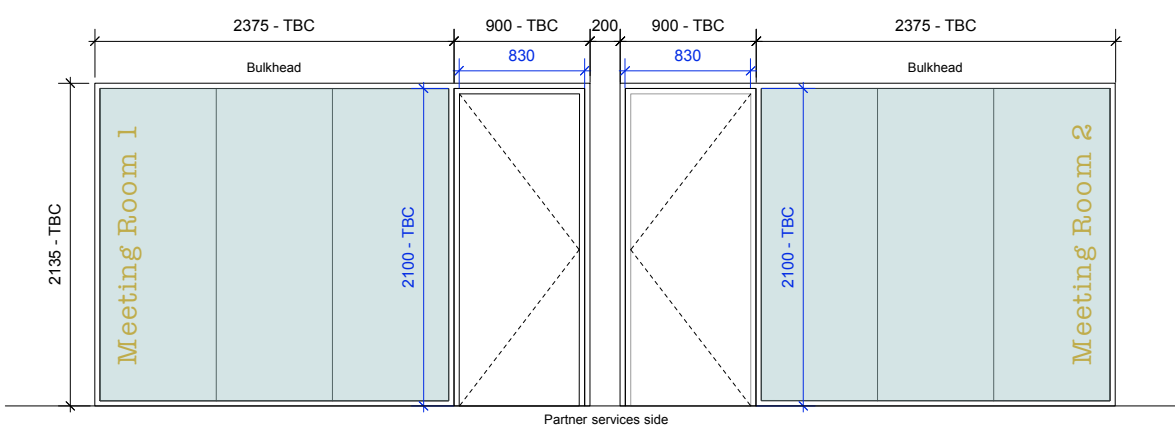

**Ref: 2D08**

**Location:** S57  
**Type:** New Glazed screen with solid core door.  
**Proposed Works:** Fixed Glazing in 2 or 3 panels with UV / silicone joint. Hinged solid core door.  
**Ironmongery:** 10 - Bronze steel 'bar' handles fixed to both sides of door. Hinges to be provided by door manufacturer. Lockable with thumbturn.  
**Fire Rating:** N/A  
**Acoustic Rating:** N/A  
**Glazing:** Toughened Glazing to BS EN 12150. Minimum 10mm thick.  
**Repair Code:** N/A  
**Finish:** Spray laquered off site finished - White or Dark Grey - Colour TBC  
**Spec Ref:** Door Spec - L20 430. Glazing - H13 120 + as described above.

**Ref: 2D09**

**Location:** S58  
**Type:** New Glazed screen with solid core door.  
**Proposed Works:** Fixed Glazing in 2 or 3 panels with UV / silicone joint. Hinged solid core door.  
**Ironmongery:** 10 - Bronze steel 'bar' handles fixed to both sides of door. Hinges to be provided by door manufacturer. Lockable with thumbturn.  
**Fire Rating:** N/A  
**Acoustic Rating:** N/A  
**Glazing:** Toughened Glazing to BS EN 12150. Minimum 10mm thick.  
**Repair Code:** N/A  
**Finish:** Spray laquered off site finished - White or Dark Grey - Colour TBC  
**Spec Ref:** Door Spec - L20 430. Glazing - H13 120 + as described above.

Ref:	Legend
	<b>Door repair codes</b>
1.	Good - sound and operational - prepare surfaces and redecorate.
2.	Intact - ease and free-up moving parts, address surface defects, adjust, redecorate.
3.	Moderate - Requires repair, adjustment, refurbishment prior to redecoration.
4.	Poor - significant repairs, alterations or new components needed to make operational. Adjust, redecorate.
5.	Beyond economic repair - remove. Prepare opening for replacement unit.

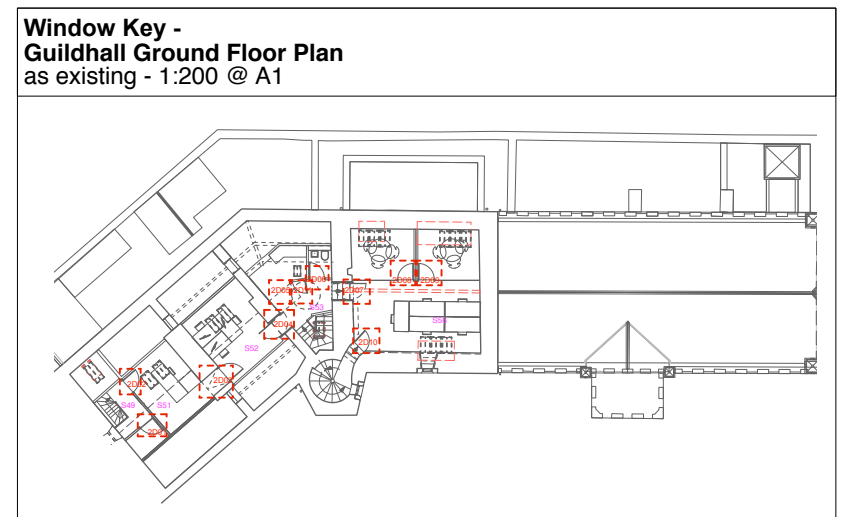

**general**

- all drawings are copyright
- do not scale drawing
- report all discrepancies to project administrator
- all dimensions to be checked on site

**key**

**notes**

**Stage 4 - Tender**

All dimensions to be checked on site.  
**Note:** Door undercuts and Louvre Panels to be confirmed by M+E Engineer

**rev**

T1: 21.03.19 - Door Updates as noted in red or bubbled  
T2: 29.03.19 - Door Updates as noted in red - Ironmongery Set

project title: <b>Tavistock Guildhall and Police Station</b>	date: October 2018	scale: 1:25 @ A1 1:50 @ A3	drawn: cm
drawing title: <b>Internal Door Schedule 5 - Second Floor</b>	job no: <b>1041</b>	drawing no: <b>C-384</b>	rev: <b>T2</b>

**gillespie yunnie architects**

Lower Tweed Mill Shimmers Bridge Dartington Devon TQ9 6JB t:01803 860010 f:01803 864929 e:info@gyarchitects.co.uk