

- Key:**
- 1 = Phase 1 works to be handed over to RMB immediately upon completion
 - . - = Chapter 8 fencing (temporary until pavement handed over)
 - . - = Site heras fencing

Le Page Architects

Le Page Architects Limited
 Plumer House
 Talylour Road
 Crowntill
 Plymouth
 PL6 5DH
 Tel: +44 (0)1752 849 880
 Email: enquiries@lepagearchitects.com
 Web: http://www.lepagearchitects.com

© Le Page Architects Ltd

Notes
 Text

this drawing must be read in conjunction with other architects, consultant's, sub-contractor's and specialist drawings.
 all dimensions are in millimetres unless stated otherwise, the contractor, before commencement of construction, if this drawing exceeds the quantities taken, in any way, the architects are to be informed before the work is put in hand.

Client
 Tavistock Town Council

Project Name
 Guildhall Carpark Public Realm

Drawing
 Proposed Site Plan
 Phase -1

Scale
 1:100 @ A1

Drawn by
 ST
 Checked by
 SCR
 Project No.
 J19/032 AB06
 Date
 Sept 2019
 Date
 Sept 2019
 Revision
 -

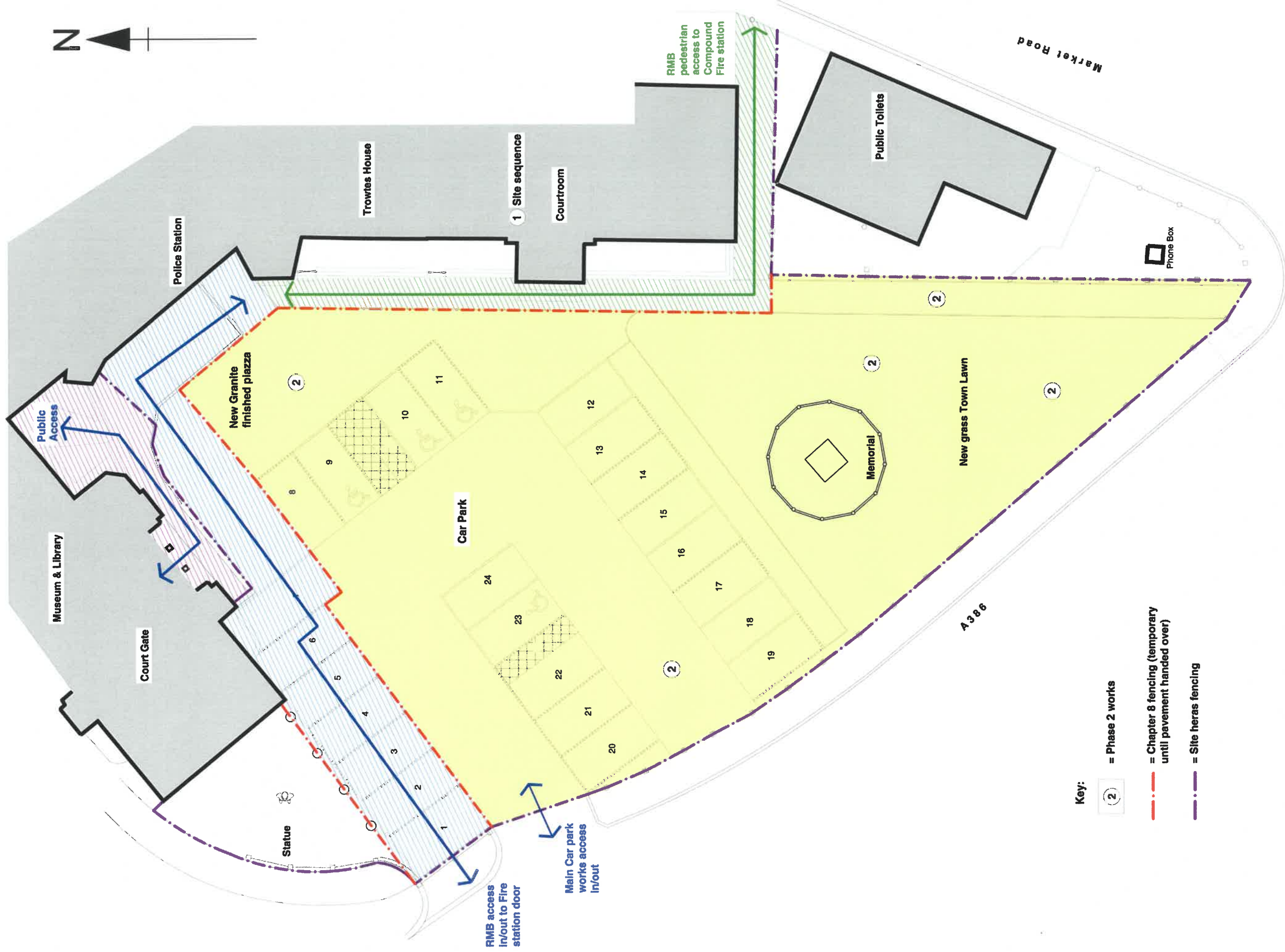
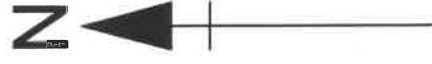

Key:



= Phase 2 works

— · — = Chapter 8 fencing (temporary until pavement handed over)

— · — · — = Site heras fencing

Le Page Architects

Le Page Architects Limited
 Plumer House
 Tailour Road
 Crownhill
 Plymouth
 PL6 5DH
 Tel: 44 (0)1752 849 880
 Email: enquiries@lepagearchitects.com
 Web: http://www.lepagearchitects.com

© Le Page Architects Ltd

Notes
 Text

this drawing must be read in conjunction with other architect's, consultant's, sub-contractor's and specialist drawings.
 all dimensions are in millimetres unless stated otherwise, all dimensions are to be verified on site and confirmed, by the contractor, before commencement of construction. if this drawing exceeds the quantities taken, in any way, the architects are to be informed before the work is put in hand.

Client
 Tavistock Town Council

Project Name
 Guildhall Carpark Public Realm

Drawing
 Proposed Site Plan
 Phase -2

Scale
 1:100 @ A1

Drawn by	ST	Date	Sept 2019
Checked by	SCR	Date	Sept 2019

Project No.	J19/032	Drawing No.	AB07	Revision	-
-------------	---------	-------------	------	----------	---

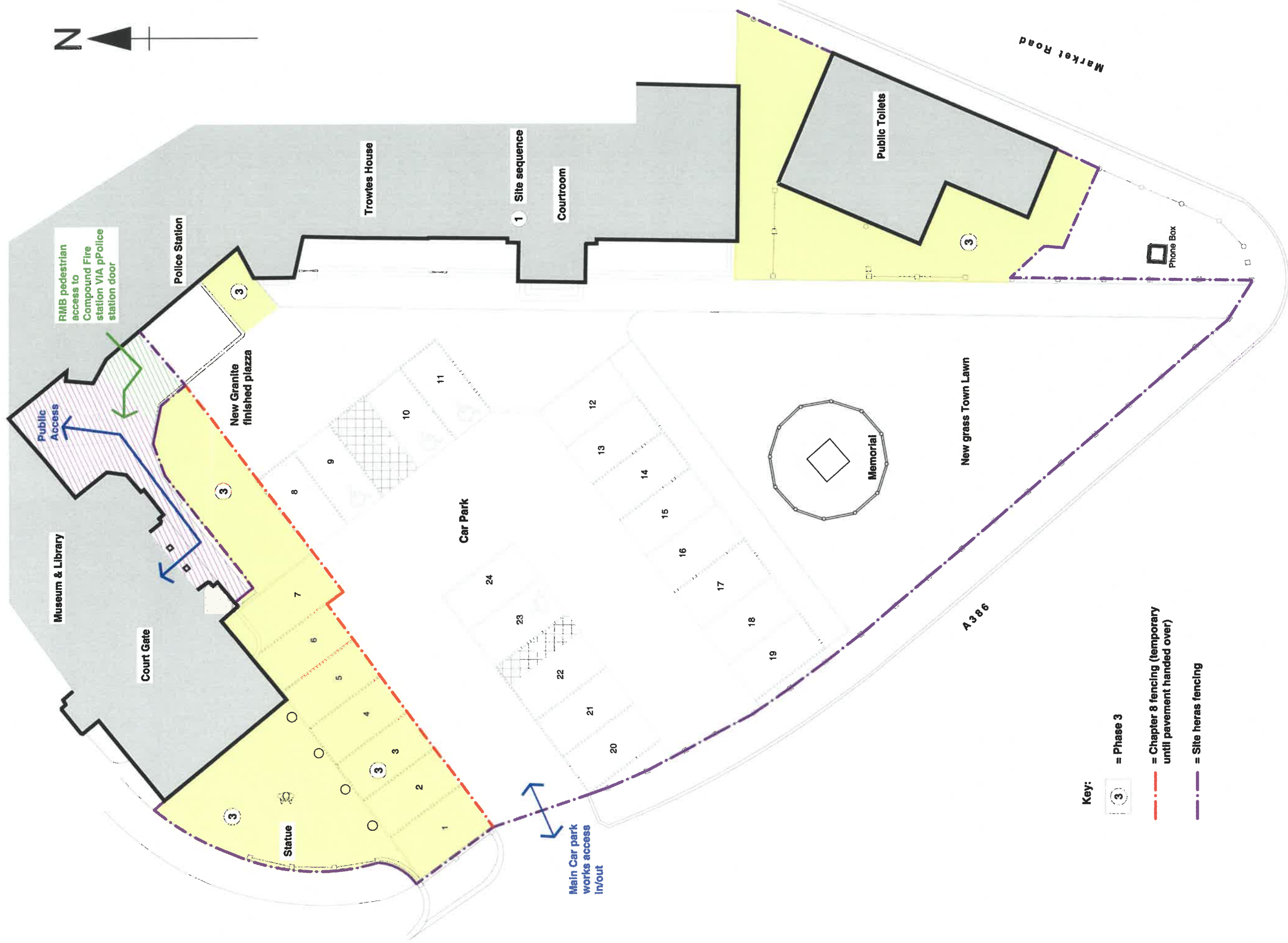
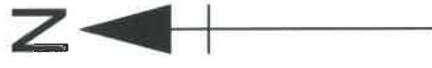

- Key:**
- 3 = Phase 3
 - = Chapter 8 fencing (temporary until pavement handed over)
 - . - = Site heras fencing

Le Page Architects

Le Page Architects Limited
 Plumer House
 Talylour Road
 Crowhill
 Plymouth
 PL6 5DH
 Tel: +44 (0)1752 849 880
 Email: enquiries@lepagearchitects.com
 Web: http://www.lepagearchitects.com

© Le Page Architects, Ltd

Notes
 Text

this drawing must be read in conjunction with other architects, consultants, sub-contractor's and specialist drawings.
 all dimensions are in millimetres unless stated otherwise. all dimensions are to be verified on site and confirmed, by the contractor, before commencement of construction. if this drawing exceeds the quantities taken, in any way, the architects are to be informed before the work is put in hand.

Client
 Tavistock Town Council

Project Name
 Guildhall Carpark Public Realm

Drawing
 Proposed Site Plan
 Phase -3

Project No.
J19/032 AB08

Drawing No
 -

Scale
 1:100 @ A1

Drawn by
 ST
 Checked by
 SCR
 Date
 Sept 2019
 Date
 Sept 2019

Revision
 -