

- NOTES
1. ALL DIMENSIONS ARE TO BE CHECKED ON SITE BEFORE THE COMMENCEMENT OF WORKS. ANY DISCREPANCIES ARE TO BE REPORTED TO THE ARCHITECT & ENGINEER FOR VERIFICATION. FIGURED DIMENSIONS ONLY ARE TO BE TAKEN FROM THIS DRAWING.
 2. THIS DRAWING IS TO BE READ IN CONJUNCTION WITH ALL RELEVANT ENGINEERS' AND SERVICE ENGINEERS' DRAWINGS AND SPECIFICATIONS. THIS DRAWING IS COPYRIGHT.
 3. ALL WORK TO COMPLY WITH THE RELEVANT BRITISH STANDARDS, CODES OF PRACTICE AND BUILDING REGULATIONS.
 4. FOR SECTIONS, SEE DRAWINGS TGH-HYD-XX-ZZ-DR-S-1300 - 1303.
 5. FOR SPECIFICATION NOTES, SEE DRAWING TGH-HYD-XX-ZZ-DR-S-1000.

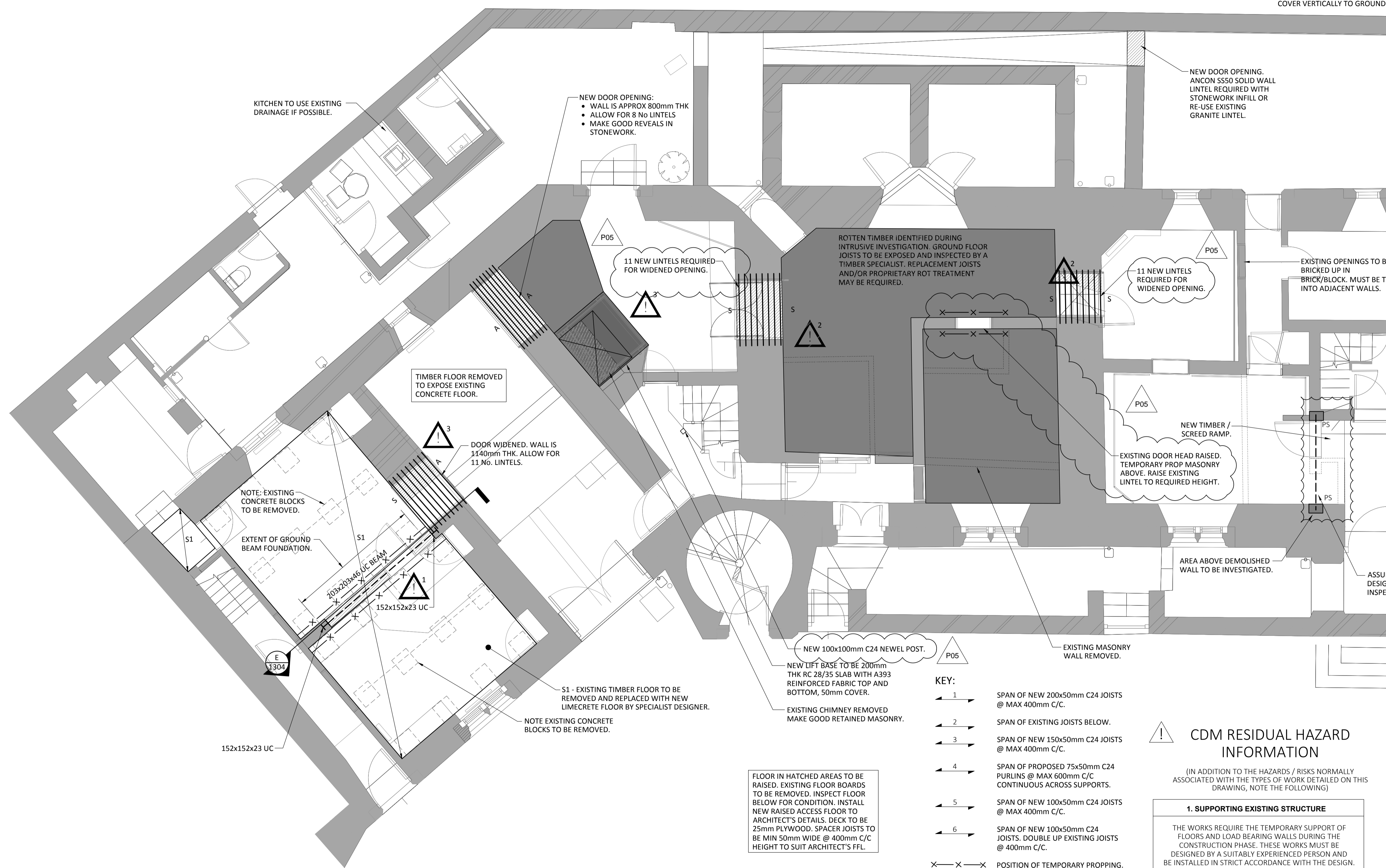

REVISIONS

REV	DATE	CHECKED BY	DATE	APPROVED BY	DATE
P05					
N.FIRTH	25/04/19	J.COATES	25/04/19	J.COATES	25/04/19
P04					
N.FIRTH	28/03/19	A.FITZHUGH	28/03/19	J.COATES	28/03/19
P03					
X.SCHUMANN	08/02/19	J.COATES	08/02/19	J.COATES	08/02/19
P02					
G.COX	17/05/17	J.COATES	17/05/17	J.COATES	17/05/17
P01					
G.COX	07/04/17	J.COATES	07/04/17	J.COATES	07/04/17
REV	REVISION NOTES/COMMENTS				
DRAWN BY	DATE	CHECKED BY	DATE	APPROVED BY	DATE

- KEY:
- 1 SPAN OF NEW 200x50mm C24 JOISTS @ MAX 400mm C/C.
 - 2 SPAN OF EXISTING JOISTS BELOW.
 - 3 SPAN OF NEW 150x50mm C24 JOISTS @ MAX 400mm C/C.
 - 4 SPAN OF PROPOSED 75x50mm C24 PURLINS @ MAX 600mm C/C CONTINUOUS ACROSS SUPPORTS.
 - 5 SPAN OF NEW 100x50mm C24 JOISTS @ MAX 400mm C/C.
 - 6 SPAN OF NEW 100x50mm C24 JOISTS, DOUBLE UP EXISTING JOISTS @ 400mm C/C.
 - X-X-X POSITION OF TEMPORARY PROPPING.
 - PS 450x215x150mm INSITU CONCRETE PADSTONE.
 - 203x133x30 UB NEW STEEL BEAM.
 - WP WALL PLATE (FACE FIXED AND HANGERS).
 - 100 NEW BLOCKWORK SLEEPER WALL.
 - D DOUBLE JOISTS.
 - 220x90mm GLULAM BEAM @ 1.8m C/C OR 225x75mm C24 TIMBER RAFTERS.
 - S STANDARD CONCRETE LINTEL ON OUTSIDE OF GROUP.
 - A STEEL ANGLE LINTEL WITH PISTOL CUT STONE ON OUTSIDE OF GROUP.

CDM RESIDUAL HAZARD INFORMATION
 ([IN ADDITION TO THE HAZARDS / RISKS NORMALLY ASSOCIATED WITH THE TYPES OF WORK DETAILED ON THIS DRAWING, NOTE THE FOLLOWING])

- 1. SUPPORTING EXISTING STRUCTURE**
 THE WORKS REQUIRE THE TEMPORARY SUPPORT OF FLOORS AND LOAD BEARING WALLS DURING THE CONSTRUCTION PHASE. THESE WORKS MUST BE DESIGNED BY A SUITABLY EXPERIENCED PERSON AND BE INSTALLED IN STRICT ACCORDANCE WITH THE DESIGN.
- 2. OPENINGS WITHIN THICK STONE WALLS**
 THE INVESTIGATION FOUND THAT SOME VOIDS WERE PRESENT WITHIN THE EXISTING WALLS, WHILE IT WAS GENERALLY FOUND THAT THE RUBBLE WAS STABLE, THIS MAY NOT BE THE CASE WHEN LARGE HOLES ARE MADE. PROCEED WITH CAUTION. IF A WALL IS FOUND TO BE LESS STABLE THAN EXPECTED, STOP WORK, SEEK ADVICE FROM THE STRUCTURAL ENGINEER. GROUTING MAY BE REQUIRED PRIOR TO PROCEEDING.
- 3. OPENINGS THROUGH CHIMNEYS**
 THE EXISTING CHIMNEYS ARE LIKELY TO CONTAIN FLUES THAT VARY IN POSITION AT EACH LEVEL. THESE MAY AFFECT THE ABILITY OF THE MASONRY TO CANTILEVER / BRIDGE OPENINGS AND THEREFORE THIS SHOULD BE CONSIDERED BY THE CONTRACTOR WHEN PREPARING THEIR METHOD STATEMENTS FOR THESE WORKS.

FLOOR IN HATCHED AREAS TO BE RAISED. EXISTING FLOOR BOARDS TO BE REMOVED. INSPECT FLOOR BELOW FOR CONDITION. INSTALL NEW RAISED ACCESS FLOOR TO ARCHITECT'S DETAILS. DECK TO BE 25mm PLYWOOD. SPACER JOISTS TO BE MIN 50mm WIDE @ 400mm C/C HEIGHT TO SUIT ARCHITECT'S FFL.

Hydrock Lobb Shippon
 Plymouth
 Plymouth
 PL7 5BP
 t: +44 (0) 1752 347515
 e: plymouth@hydrock.com

CLIENT
TAVISTOCK GUILDHALL

PROJECT
TAVISTOCK GUILDHALL

TITLE
LOWER GROUND FLOOR PLAN SHEET 1

HYDROCK PROJECT NO.
C-03482 SCALE @ A1
1 : 50

STATUS DESCRIPTION
SUITABLE FOR TENDER D2

DRAWING NO. (PROJECT CODE-ORIGINATOR-ZONE-LEVEL-TYPE-ROLE-NUMBER)
TGH-HYD-XX-LG-DR-S-1001 REVISION
P05