

THIS DRAWING MUST BE READ IN CONJUNCTION WITH OTHER ARCHITECT'S, CONSULTANT'S, SUB-CONTRACTOR'S AND SPECIALIST DRAWINGS.

ALL DIMENSIONS ARE IN MILLIMETRES UNLESS STATED OTHERWISE.

ALL DIMENSIONS ARE TO BE VERIFIED ON SITE AND CONFIRMED, BY THE CONTRACTOR, BEFORE COMMENCEMENT OF CONSTRUCTION.

IF THIS DRAWING EXCEEDS THE QUANTITIES TAKEN, IN ANY WAY, THE ARCHITECTS ARE TO BE INFORMED BEFORE THE WORK IS PUT IN HAND.

Key:

- Site boundary (hoarding)
- Site boundary (existing hedge)
- Scaffolding (4 boards width - to have vertical ranch boarding up to 4m height all round - All external ladders to be removed at end of each working day - any temporary scaffold towers to be removed at end of each day). Scaffold to be sheeted with Monarflex acoustic sheathing all round

Rev	Date	Revision	By	Chk
A	02/04/26	Notes updated	AB	SCr
B	08/04/26	Notes Updated	ST	SCr

Notes

### Le Page Architects

Le Page Architects Limited  
 Plumer House  
 Tallyour Road  
 Crownhill  
 Plymouth  
 PL6 5DH  
 Tel: +44 (0)1752 849 880

Email: [enquiries@lepagearchitects.com](mailto:enquiries@lepagearchitects.com)  
 Web: <http://www.lepagearchitects.com>

Client  
**Tavistock Town Council**

Project Name  
**Betsy Grimbal and Still House  
 Repair Work**

Drawing  
**Betsy Grimbal - Phase 1  
 Phase 1 Site Compound Layout**

Scale 1:100 @ A3

Drawn by  
 AB  
 Date  
 12/03/26  
 Checked by  
 SCr  
 Date  
 13/03/26

Project No. Drawing No Revision

**J26.014 AL.02 B**

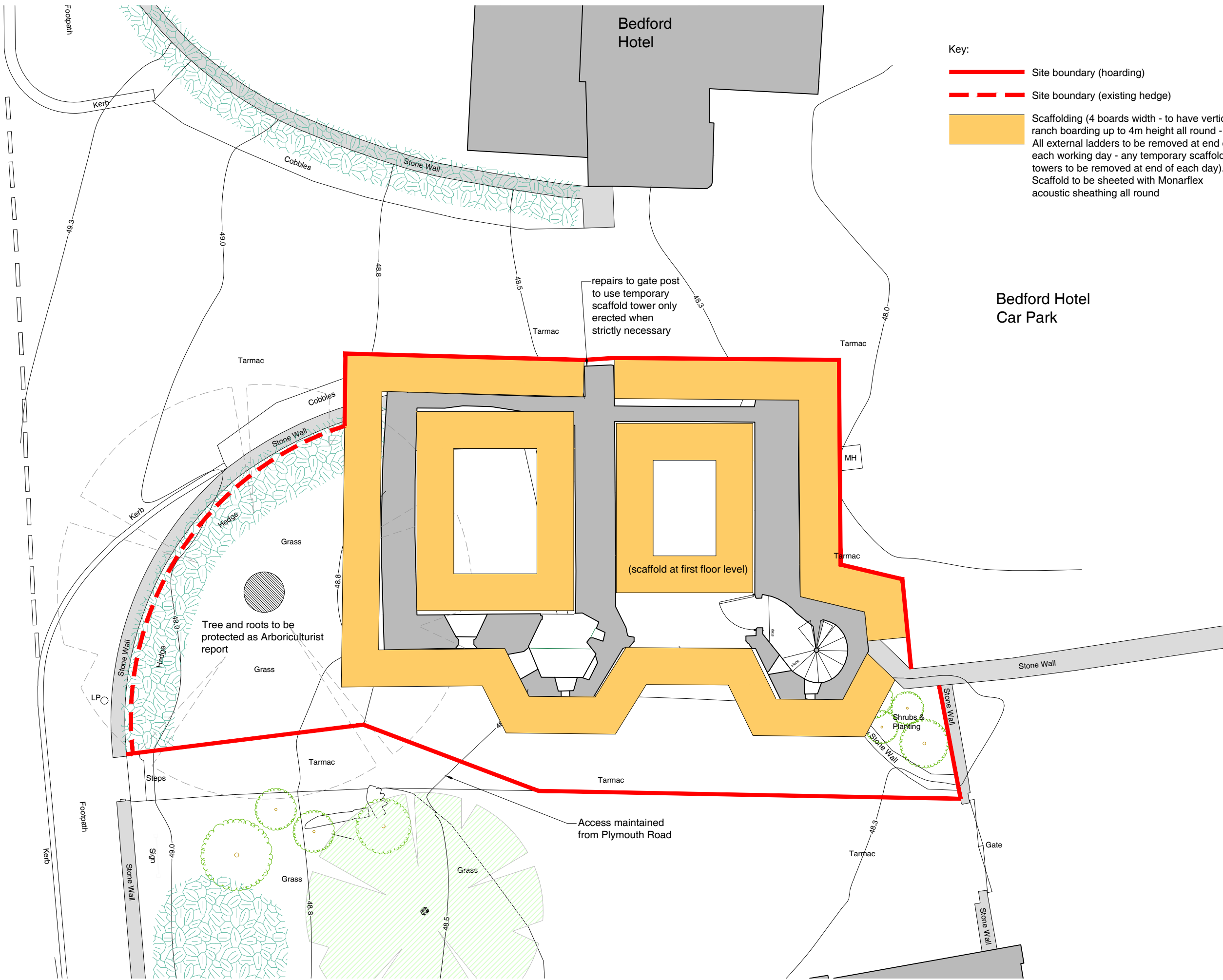

# 01 Betsy Grimbal Phase 1 - Site Layout

Scale 1:100

